



NEKTAR THERAPEUTICS

Scientific Workplace



PROJECT NAME
Scientific Workplace

CLIENT
Nektar Therapeutics

SIZE
24,000 Gross Square Feet
20,000 Net Square Feet

LOCATION
San Francisco, California



VALUES
Creativity. Entrepreneurial Ideas. Integrity. Access.

MISSION
Developing groundbreaking therapies by unleashing the true potential of critical biological pathways.

PROGRAM
Promoting an Interactive Workplace

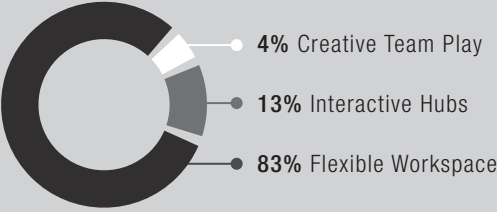

fostering new pathways to

innovative medicines with design

design challenge

Nektar Therapeutics challenged our team to deliver a workplace model that inspires, companywide. Flad designed a rejuvenated workplace setting that provides a fresh, restorative identity for its users.

Employees from other floors and departments have also recognized its value and gravitate to the community spaces, setting a new bar for enhanced productivity and employee satisfaction.





THE POWER OF LIGHT

Based on regulating circadian rhythms, the design team applied a human-centric lighting strategy that pulls natural light into the deepest core of the floor

plan. Increasing natural light holds the promise to reduce stress, improve decision making, and enhance productivity while activating health and well-being.



MINDFUL WORKPLACE

Woven throughout the design is the concept of expansion and contraction – inspired by the rhythm of breathing. This is showcased in the ceiling, which

undulates in symmetrical waves. Advanced audio-visual features hidden behind these waves are quickly lowered to enable a user-friendly technology experience.





the art of noise

To achieve separation between collaboration and privacy settings, Flad designed a graduated experience where pathways flow from activated, vocal collaboration zones from the entry and core into quiet, mindful contemplative zones along the office perimeter. This layered approach reduces noise pollution, reinforces a personalized environment, instills productive work habits, and improves the quality of work.



In some cultures, oceanic ecologies represent wealth and luck. The movement of water and the act of swimming encourages balance, healing, and calm. Nektar incorporated an aquarium in the lobby – not

only to set a soothing atmosphere but to also provide an interactive tool that intuitively encourages guests and others to engage with one another.

cultivating connection

Nektar employees are unwavering in their drive to discover new pathways to smarter medicines® that heal patients, setting a robust foundation for life-changing biology™. Their approach to developing new therapies has been termed “smart pharmacology” which customizes the behavior of a new molecule to hit the right target in the right place at the right time.

The design team incorporated this cultural breakthrough into every aspect of the design, setting a new bar for creating a functional experience that connects every individual to their work and to the impact their work has on patients every day.



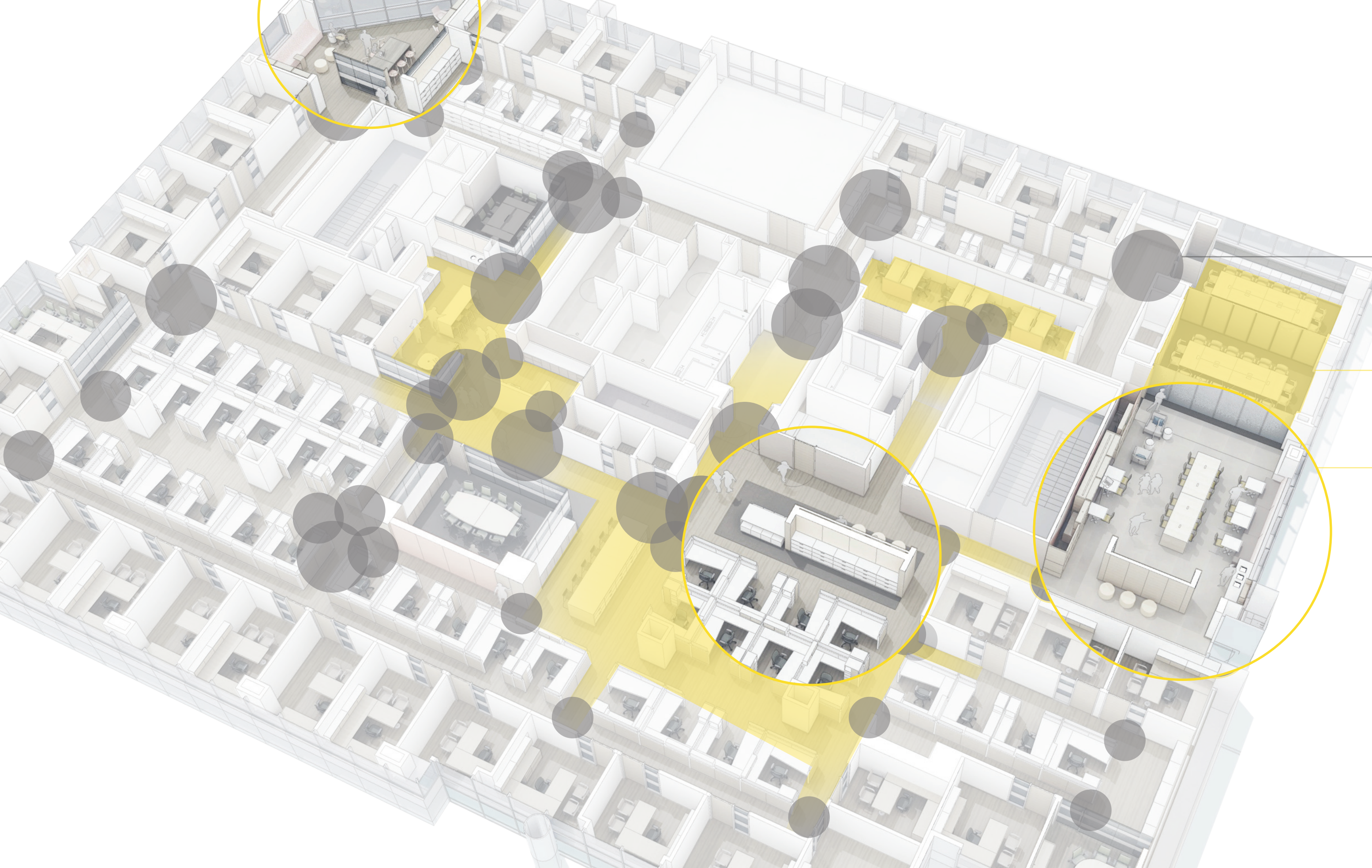

meaningful interactions

A COLLISION OF IDEAS

Impromptu social collisions connect every individual, not only to their work but the work of their peers, delivering a culture that celebrates the impact their work has on patients every day.

A PROMOTION OF TEAM PLAY

The overall floor plan had to be flexible to promote interaction among a growing and agile workforce. Ideation, brainstorm zones morph from 6 to 150 people.

A FOUNDATION FOR INVENTION

Three critical interactive hubs along the activated perimeters encourage impromptu meetings. These interactions provoke scientific breakthroughs that spearhead new cures.



changing workflows



Movable wall panels allow three small rooms to morph into one large gathering space. The community room can now accommodate a large, all-hands meeting;

small problem-based working groups; and ad hoc brainstorming work sessions. This is just one example of how the design leveraged every inch of space.





where art meets science



We blended a soft neutral palette leveraging Nektar's branded orange theme while adding deeper tones inspired by the Golden Gate Bridge and California sunsets. Nature-inspired

materials of milled white oak, soft linen textures, grass cloth, natural felted wool, and hand-drawn sierra pine trees on glass partitions connect users to the region. All materials

were of local origin and made from renewable sources. A process video, at vimeo.com/91622252, describes the artist and genesis of the handcrafted "goldfish" tables.

impact

Our work with Nektar has allowed them to realize several goals: Promote visibility and access to people, information, ideas, and decisions; allow staff to see beyond their neighborhood; optimize access to natural light, thus enhancing performance and increasing employee satisfaction; and balance equal desire for both interactive zones and private, focused areas.

*designed to increase
productivity & staff
satisfaction by*



20%

*low glass partitions
increase access to
light and views by*



50%



Chris' Team
(Tuesday)

Ali's Group
(Friday)

$$25\% \text{ of } 60 = (25+100) \times 60 = 0.25 \times 60 = 15 (2.0\%) =$$

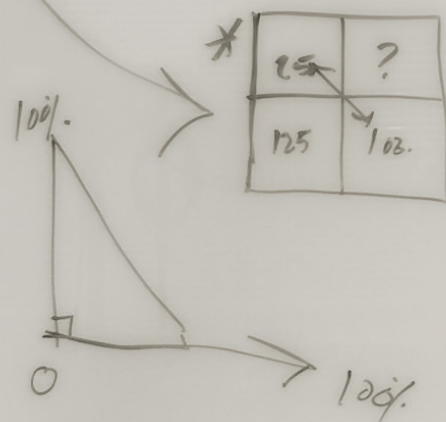

John
- 1st
- 2nd
- 3rd

X Yes!

$$100\% = 100 - 100$$

